



# Quick Consumer Manual



# Welcome

Thank you for purchasing a Speed Queen® appliance. We value you as a customer.

At Speed Queen, leading performance is our daily reality. We seek to deliver an outstanding experience in every aspect of laundry. Your machine was built to last 25 years in your home and Speed Queen support has been built to provide you with the best service in the industry.

## Installation

### Parts included:



1. Move unit to area within 4 ft (1.2 m) of final installation.
2. Remove shipping materials.
  - Remove lower panel (2 screws)
  - Remove four (4) bolts securing shipping brace. Remove brace and blue label
  - Remove two (2) bolts from rear of washer
  - Insert two (2) plugs into rear bolt holes
  - Reinstall panel
3. Connect fill hoses – water pressure = 20-120 psi [138-827 kPa].
  - Flush water supply lines
  - Use two filter screen washers with screen facing tap
  - Use two rubber washers in end of hose connecting to the machine
4. Connect drain hose to drain receptacle – 36 in. [91 cm] recommended height.
  - Use beaded strap to secure drain hose to drain receptacle
5. Gas models – connect gas supply pipe. Gas service to a gas dryer must conform with the local codes and ordinances and be connected by a licensed professional. *Refer to installation instructions, which can be found at [speedqueendoc.net](http://speedqueendoc.net)*
  - Tighten all connections securely but do not overtighten to avoid breaking or bending the gas valve bracketTurn on gas and check all pipe connections (internal and external) for gas leaks by applying a non-corrosive leak detection fluid to the fittings. If bubbles are present then a leak is likely.  
Retighten connections and recheck for leaks.

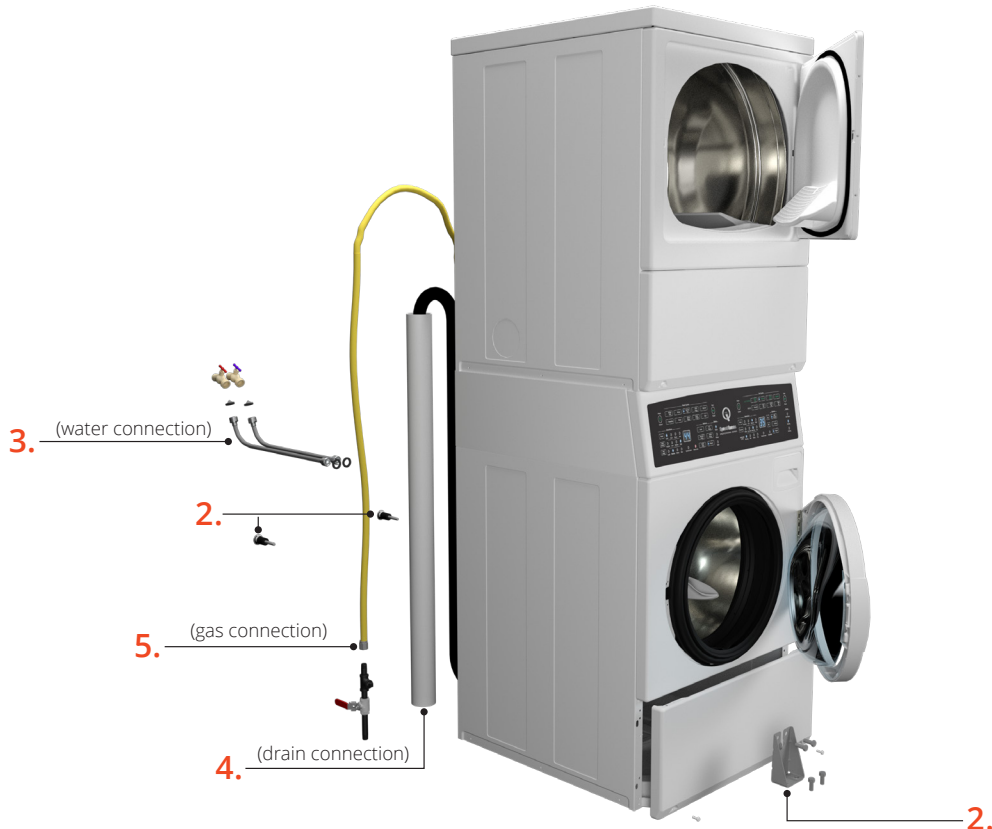

# Installation (continued)

6. Connect exhaust system.
  - Dryer must be exhausted to the outdoors
  - Use 4 in (102 mm) rigid duct
  - Maximum straight duct length = 65 ft (19.8 m). Each elbow deduct 10 ft (3 m)
  - Sufficient make-up air must be supplied. The free area of any opening for outside air must be at least 40 in<sup>2</sup> (25806 mm<sup>2</sup>) per unit
7. Position and level the unit.
  - Recommended rear clearance minimum is 2 in (51 mm) for utility connections and 6 in (152 mm) when venting through rear of unit
  - Tighten locknut after final adjustment
  - Place four (4) rubber feet on leveling legs
  - Unit must not rock
8. Wipe out inside of washtub and dryer drum.
9. Connect washer and dryer to electrical power – on individual branch circuit. Refer to serial plate for electrical ratings.
10. Run washer through one complete cycle to make sure it is operating properly and properly leveled.
11. Check for leaks.
12. Start dryer and check that dryer is heating.

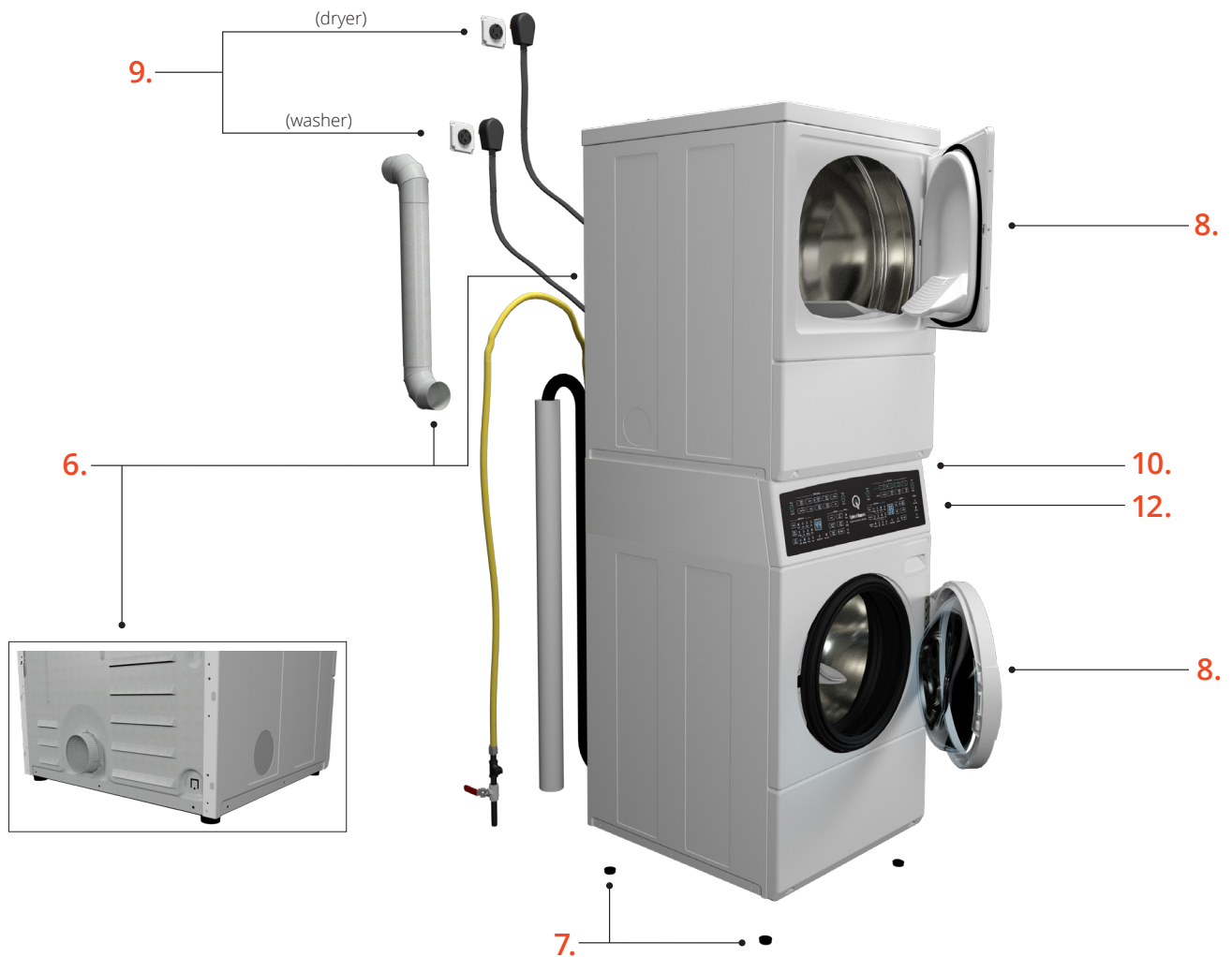

# Operating

## Washer

1. Prepare laundry
2. Add high efficiency (he) laundry supplies\*
3. Load laundry 10 kg maximum loading capacity
4. Close door
5. Set cycle



6. Set temperature
7. Set spin speed
8. Set soil level
9. Press start/pause

\*Note: Pods must be placed in washtub with laundry.

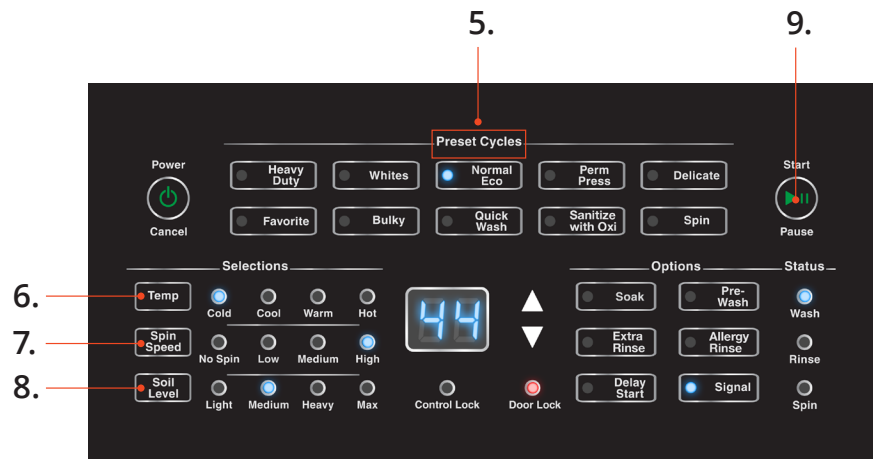

# Operating

## Dryer

1. Prepare laundry
2. Clean lint filter by wiping lint out of screen area
3. Load dryer half full with laundry 9 kg maximum loading capacity
4. Close door
5. Turn on dryer by pressing power/cancel
6. Set cycle
7. Set temperature or fabric selector
8. Set dryness level
9. Press start/pause
10. Remove laundry from dryer once cycle has ended

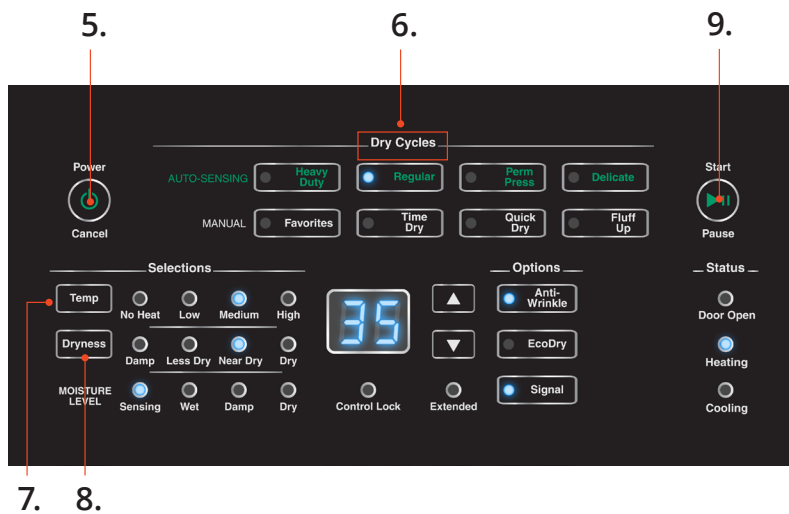

Download full documentation and view installation and operating videos for an immersive experience at [Speedqueendoc.net](http://Speedqueendoc.net) or scan the QR code below.

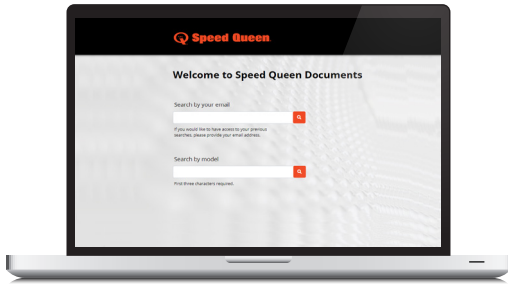

If you wish to receive printed documents at no cost, please complete the order form and return by mail to the address below, or email your request to [technicalcommunications@alliancels.com](mailto:technicalcommunications@alliancels.com).

Alliance Laundry Systems  
Technical Communications  
Shepard Street  
P.O. Box 990  
Ripon, WI 54971  
United States



## Order Form for Printed Documentation

Model No. \_\_\_\_\_

Serial No. \_\_\_\_\_

Name \_\_\_\_\_

Address \_\_\_\_\_

Phone No. \_\_\_\_\_

Email Address \_\_\_\_\_

Part No. 807604  
May 2019  
© Published by permission of the copyright owner –  
DO NOT COPY or TRANSMIT  
Speed Queen by Alliance Laundry Systems